

Pine Lake Park Master Plan

April 2024

A **long-term vision and phasing plan** for the 21-acre, former Pine Lake School property



Pine Lake Park Master Plan

- WBParks had discussions with BH Schools for several years
- Initial ideas for use of the property as a park were developed in 2022
- WBParks and BH Schools signed agreement for 20-yr lease in 2023



Pine Lake Park

WB Parks now manages the property

- October 2023 'Opening'
- Completed a boundary survey
- Completed a topographic survey
- Installed a Pine Lake Park sign at entrance
- Mowing (leaving some areas as no mow spaces)
- Tree management (dead/low hanging)
- Repaired one playground and removed aging and unsafe play equipment
- Installed dog waste pickup station and trash receptacles



Pine Lake Park

It's a **beautiful** property, but the facilities are no longer in the best condition.

This plan for Pine Lake Park imagines what the ideal would be for the property and then outlines a strategy for how to phase in improvements over time.





Pine Lake Park Master Plan

April 2024

Process

- ✓ On-Boarding Mtg (*November 2023*)
- ✓ Develop Draft Concept (*December*)
- ✓ Sub-Committee Review + Feedback (*January 2024*)
- ✓ Online Survey to Gather Public Feedback + Gauge Priorities (*February + March*)
- ✓ Finalize Concept Plan + Phasing Plan + Cost Estimates + Leadership Review Mtg (*March + April*)
- ☐ **Begin implementing the initial phase of improvements in 2024 and 2025**





Pine Lake Park Public Feedback

- Shared a concept plan with the public and gathered feedback via an online survey (Feb-March 2024)
- 335 people completed the survey (89% residents)
- 52% of respondents live in the area near the park and 80% said they could/would bike or walk to the park
- 34% ages 35-44
- 62% have someone under 18 in their home

We want your input!



Help shape the future of Pine Lake Park by completing a Master Plan Survey by March 11th, 2024.

View concept plans and take our Master Plan Survey at wbparks.org/pine-lake-park

Pine Lake Park Public Feedback

People are most excited to see:

- Looping and connected trails (69%)
- Playground (55%)
- Preservation of the wooded area (54%)
- Courts (pickleball, tennis, basketball) (47%)
- Gathering spaces, small seating areas, shade, flexible open space (47%)

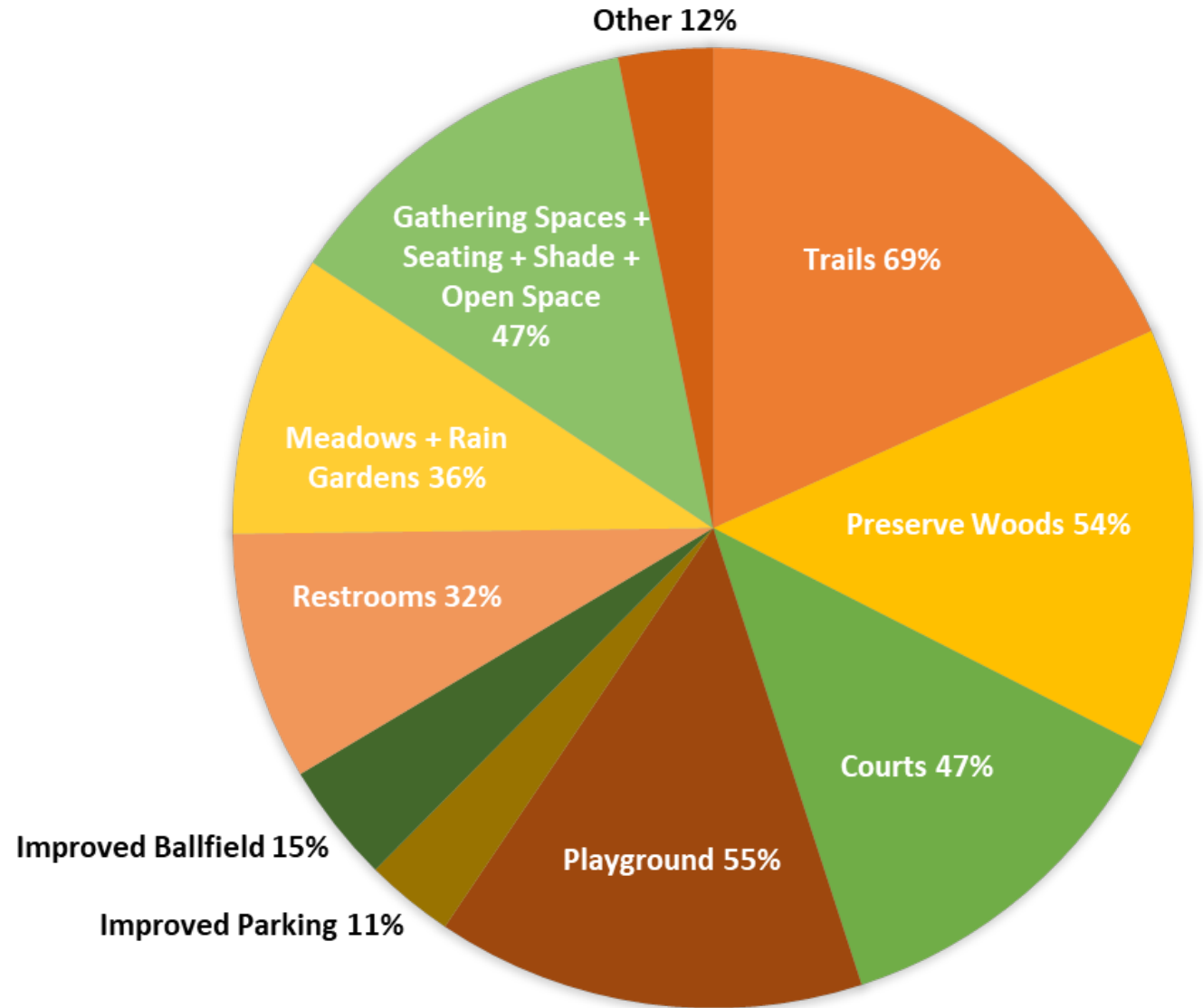

Pine Lake Park Public Feedback

Top Concerns:

- Timing of park development – don't want it to take too long
- Want a decent sized playground
- Ensure safety and privacy for adjacent homes
- Preserve nature
- Want permanent restrooms
- Several want off-leash dog area (not permitted with agreement with school district)
- Not enough pickleball courts
- Not enough parking
- Long-term funding





Pine Lake Park

Public Feedback

What should be done first?

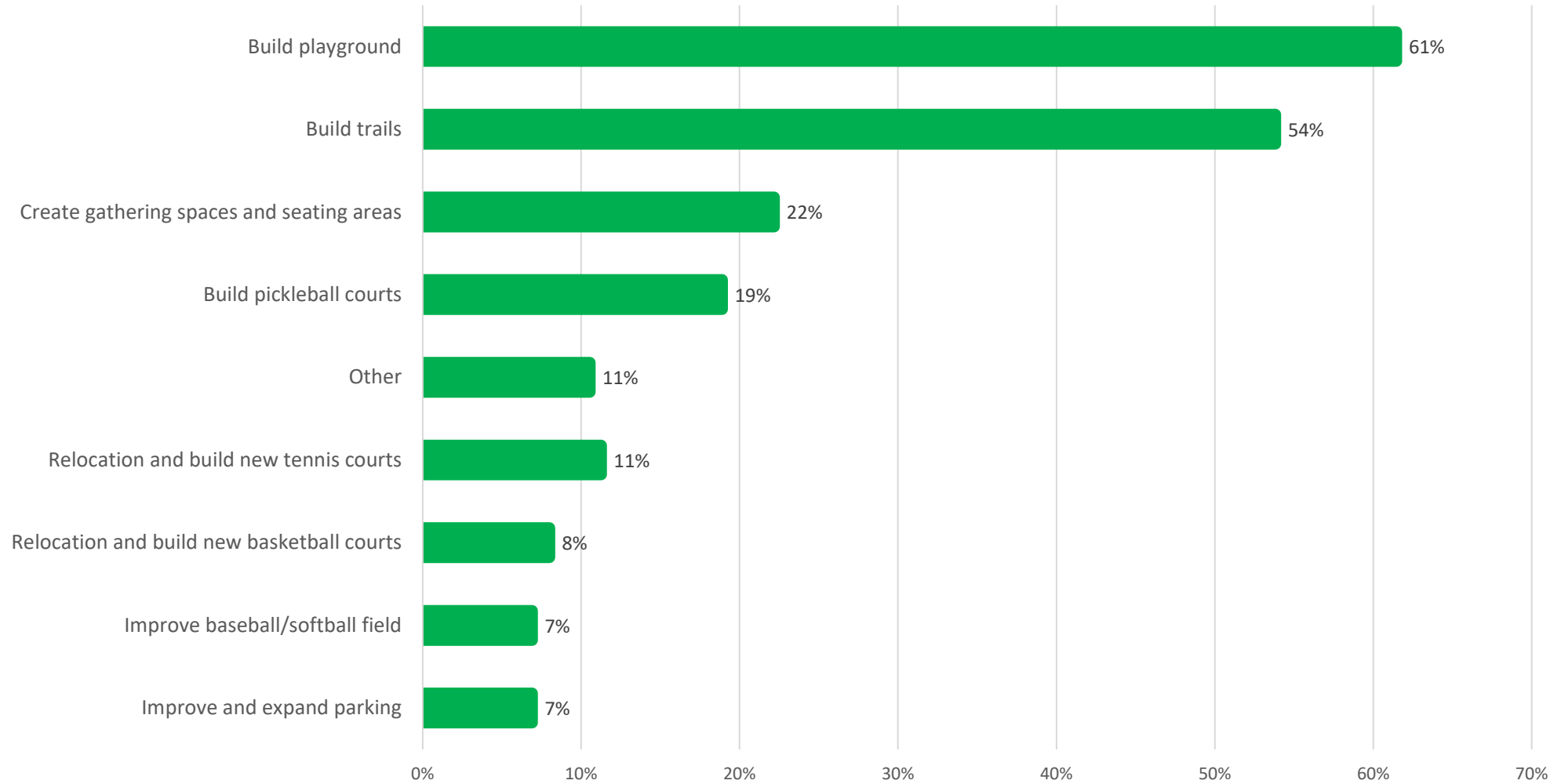



Pine Lake Park Master Plan

April 2024

- Trails + connection to Long Lake Road and adjacent neighborhoods
- Maintain Wooded Area
- Establish Meadow Areas
- 1 large playground + 1 small play area
- Expanded Ballfield
- Expanded Parking (~120 spaces)
- 4 Pickleball Courts
- 2 Tennis Courts
- 1 Full Basketball + 2 Half Courts
- 2-3 Porta Johns



Example Images

Trails + Meadows + Woods + Education

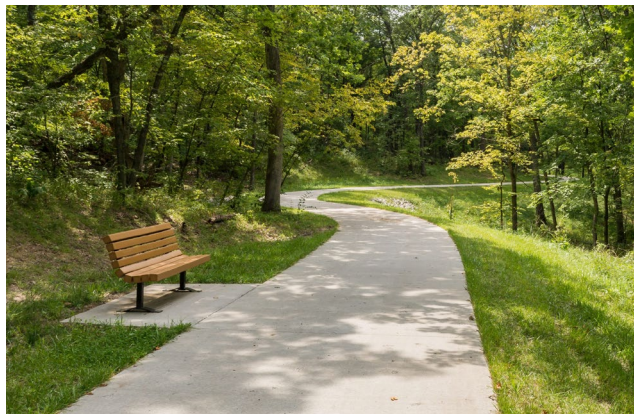



Example Images

Courts + Gathering Area + Open Space

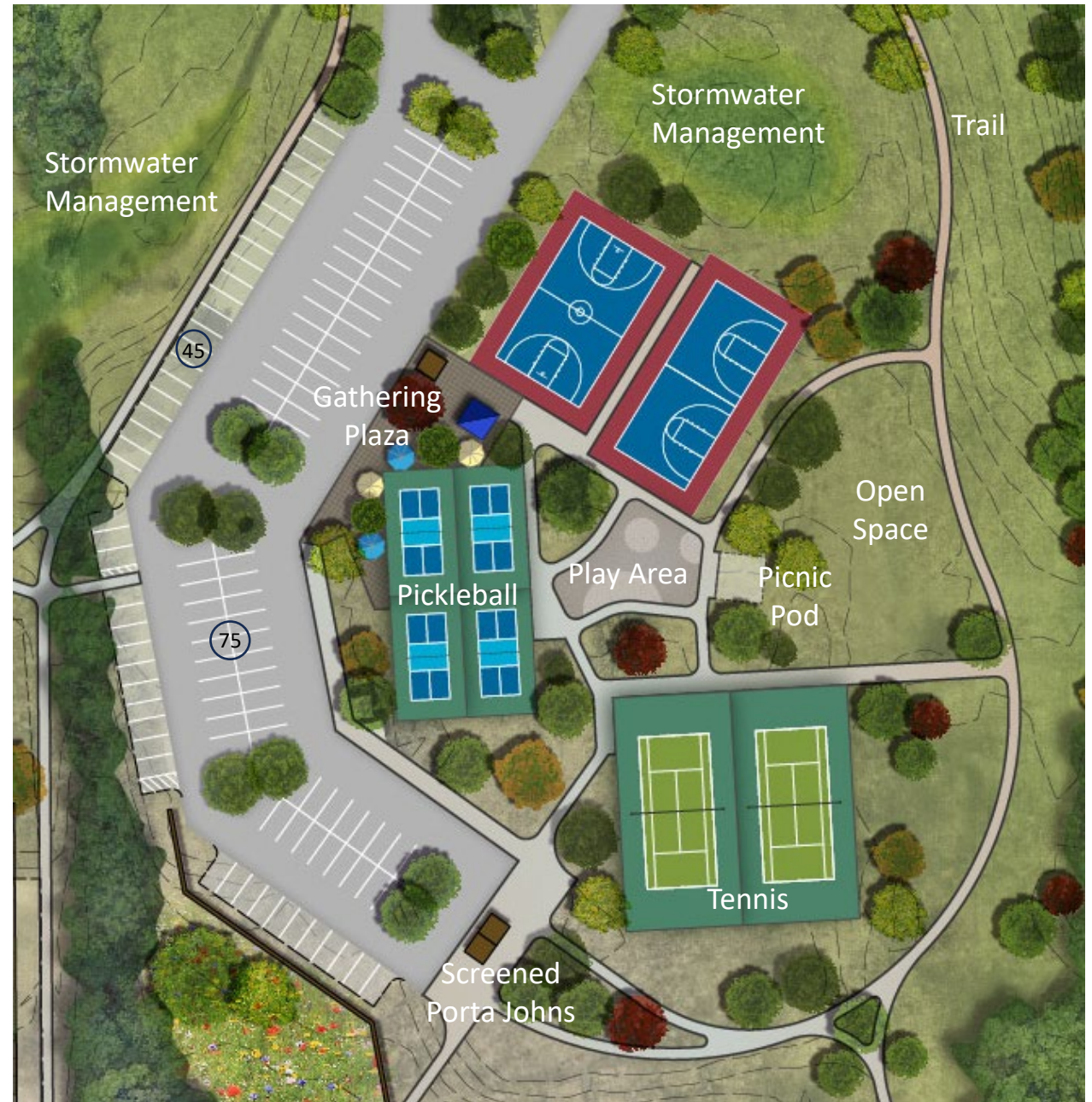



Example Images

Gathering Area

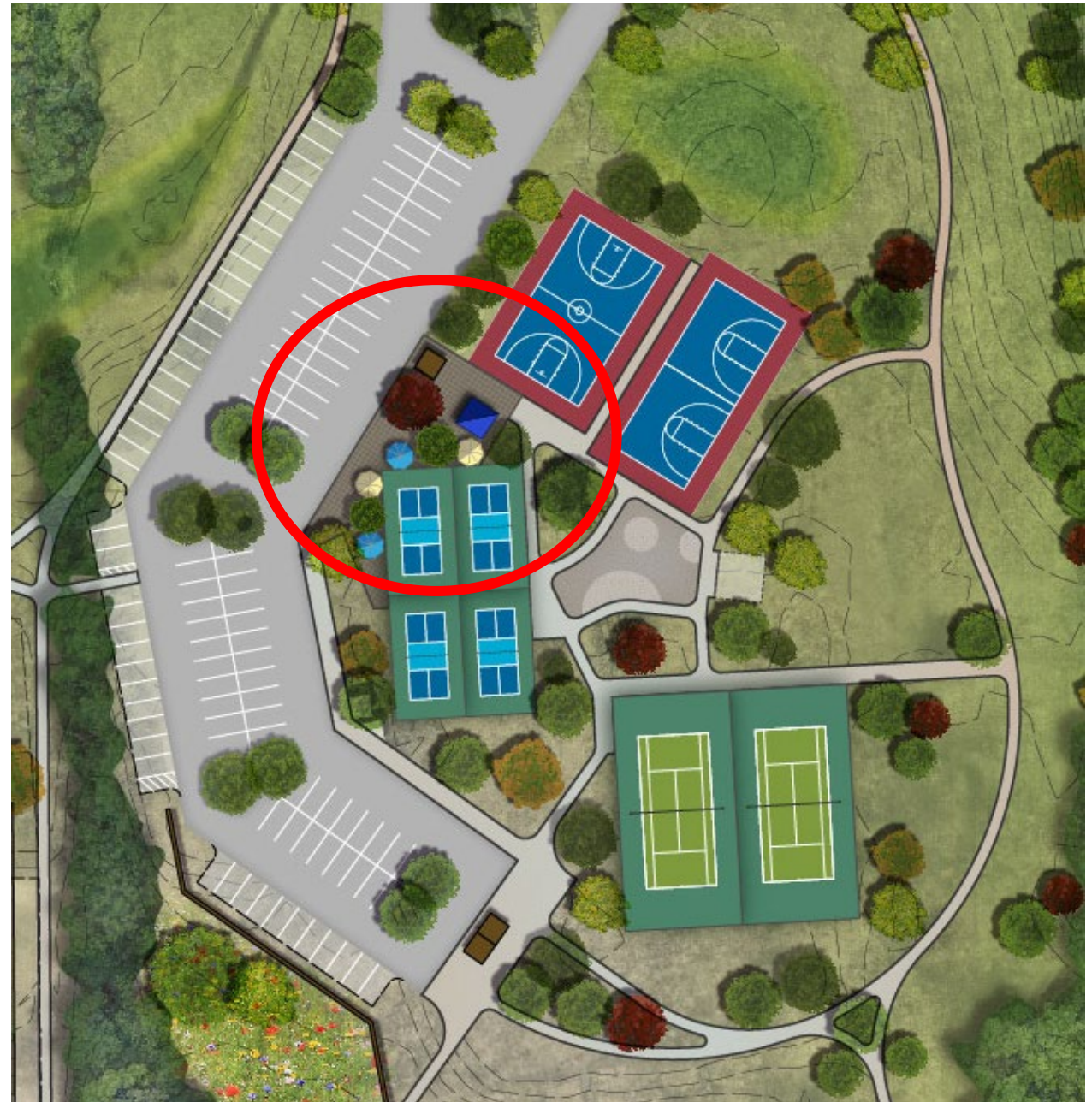



Example Images

Screened Porta Johns

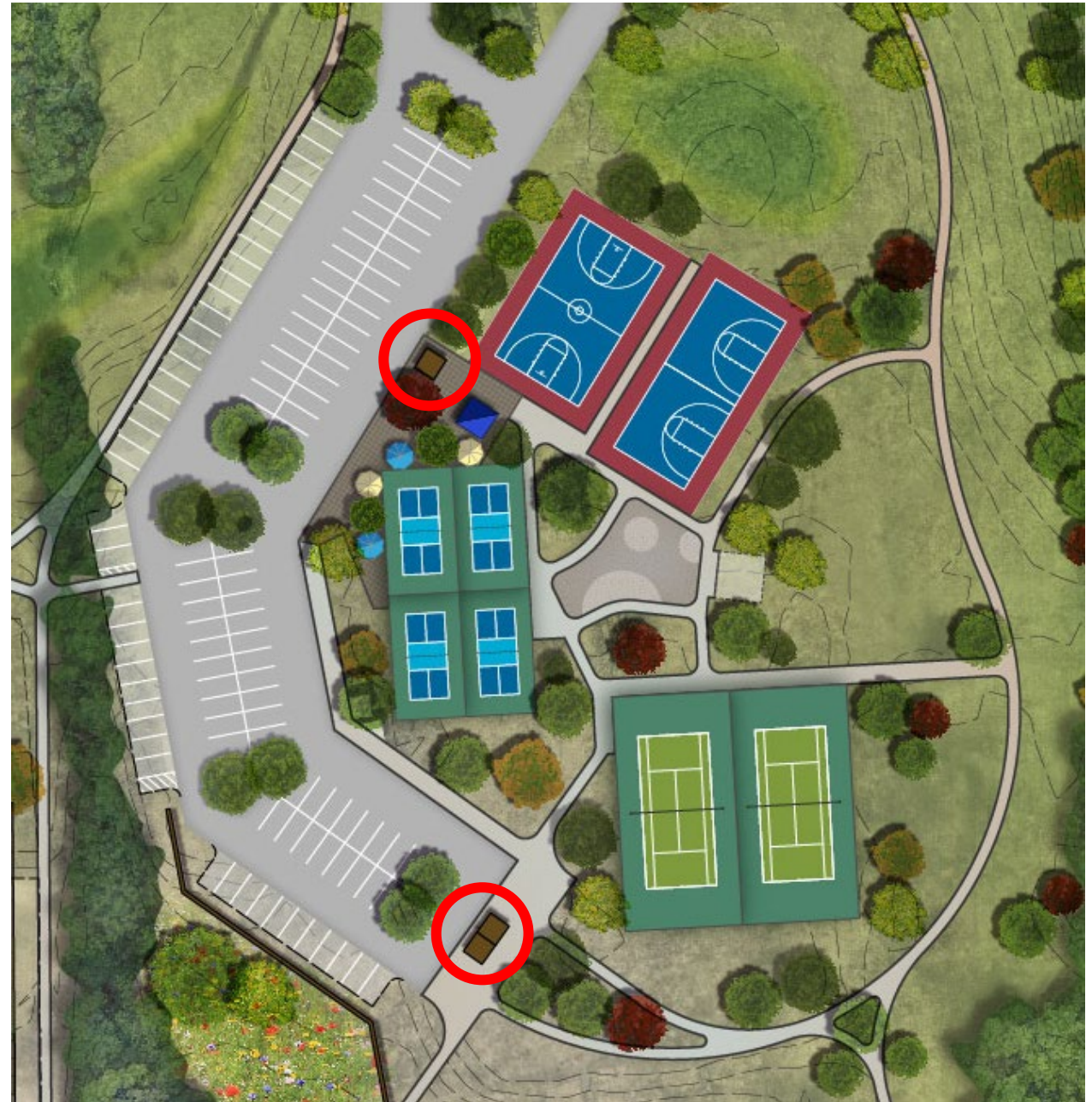



Example Images

Playground + Nature Exploration

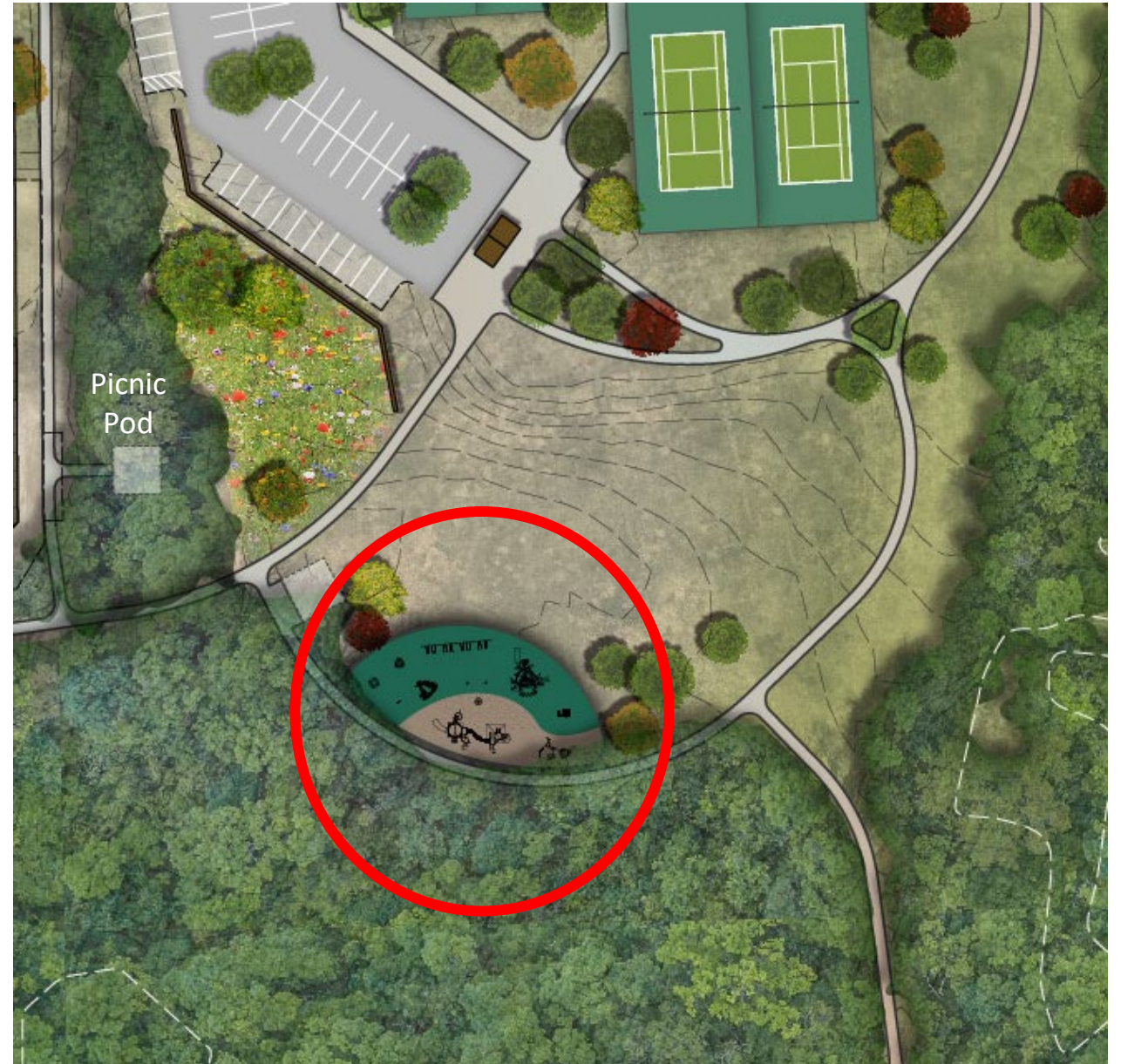

Example Images

Playground + Nature Exploration

